

AMG150 4/6/8 CHANNEL INDUSTRIAL GIGABIT 30/60/90W POE INJECTORS



Industrial Ethernet Solutions

AMG's industrial PoE injectors provide 30W or 60/90W of power injection on four, six or eight Gigabit Ethernet ports. Provided with dual power supply inputs and dual fault relays as standard ensures maximum system reliability.



Gigabit up to x4	Gigabit up to x8	Temp -40°C~+75°C	Mounting DIN/Surface	PSU x2 Dual

[AMG150 Series]

/ OVERVIEW

Designed in compact DIN rail or wall mount housings, the AMG150 series industrial Power over Ethernet (PoE) injectors are ideally suited for providing power to remote edge network devices.

Available with multiple ports in both IEEE802.3at 30W or IEEE802.3bt 60/90W they are suitable for powering the latest high powered PoE devices over a wide industrial operating temperature range.

Four, six or eight full speed 10/100/1000BASE-T(x) ports provide Ethernet In along with Ethernet Out plus 30, 60 or 90W IEEE active PoE (Passive PoE not supported).

Fitted with dual redundant power inputs and both power and PoE failure alarm relays ensures maximum operating reliability and the highest levels of performance with notification on failure.

A wide range of models are available to suit all design requirements.

PSUs need to be ordered separately.

/ FEATURES

- Innovative thermally efficient housing ensures high levels of device reliability under full load
- -40°C to +75°C temperature maintains performance in extreme conditions
- Plug & Play – no need for any user configuration
- DIN rail or wall mountable – quick to install and remove for maintenance
- Power supply & PoE fault relay outputs
- Gigabit multirate RJ45 ports support all standard 10/100/1000Mb speeds
- Dual redundant power inputs
- Supports 15W, 30W, 60W and 90W PoE
- Transparent to all traffic types including Jumbo Frames, VLAN's and Multicast etc
- Manufactured in the United Kingdom
- AMG Lifetime Support Warranty

Specifications.

Standards.

IEEE802.3i	10Base-T
IEEE802.3u	100Base-TX
IEEE802.3ab	1000Base-T
IEEE802.3af	15W PoE
IEEE802.3at	30W PoE+
IEEE802.3bt	60 & 90W PoE
Jumbo Frames	Transparent to Jumbo Frames
VLAN Support	Transparent to VLAN traffic
Multicast Support	Transparent to Multicast traffic

Interface.

LED Indicators	2x Power PoE
RJ45 Ports	4, 6 or 8x 10/100/1000T(X) RJ45 In/Out with 1.5kV Isolation Protection
Power/Relay	1x 8-Way Screw Terminal

Power.

Power Inputs	2
Operating Voltage	48-56V _{DC} (30W PoE Models) 52-56V _{DC} (90W PoE Models)
Power Consumption	2W Max (without PoE Load)
Total PoE Budget	480W Max (model dependent)
PSE Modes	Mode A (30W Ports) Mode A, Mode B (60/90W Ports)
Protection	Reverse Polarity, Overload Current
PSU Fault Relay	Form A 60V @ 2A Max
PoE Fault Relay	Form A 60V @ 2A Max

Packaging.

Shipping Weight	1.25kg / 2.76lb (4 & 6 Port Models) 1.5kg / 3.31lb (8 Port Models)
Dimensions	(W x D x H)
4 & 6 Port Models	192 x 162 x 70 mm 7.56 x 6.38 x 2.76 in
8 Port Models	220 x 188 x 70 mm 8.66 x 7.40 x 2.76 in

Mechanical.

Housing	Anodised Aluminium
Dimensions:	(W x D x H) (Excluding Wall Brackets)
4 & 6 Port Models	59 x 92 x 126 mm 2.32 x 3.62 x 4.96 in
8 Port Models	59 x 123 x 156 mm 2.32 x 4.84 x 6.14 in
IP Rating	IP40
Installation	Wall Mount or DIN-Rail
Weight	1kg / 2.20lb (4 & 6 Port Models) 1.25kg / 2.76lb (8 Port Models)

Environmental.

Operating Temp.	-40°C to +75°C
Storage Temp.	-40°C to +85°C
Humidity	5% to 95% (non-condensing)
MTBF	>250,000 hours
MTBF Standard	Telcordia SR-332 GF 30°C
Heat Dissipation	416 BTU/h (4x 30W PoE) 1030 BTU/h (2x 90W + 4x 30W PoE) 826 BTU/h (8x 30W PoE) 1645 BTU/h (4x 90W + 4x 30W PoE)
Cooling	Passive Cooling
Noise Level	0 dBA

Regulatory.

Safety	IEC/EN 62368-1
EMI	EN 55032 Class A CISPR 32 FCC Part 15B Class A
EMS	EN 61000-4-2 (ESD) EN 61000-4-3 (RS) EN 61000-4-4 (EFT) EN 61000-4-5 (Surge) EN 61000-4-6 (CS) EN 61000-4-8 (PFMF)
Shock	IEC 60068-2-27
Free Fall	IEC 60068-2-32
Vibration	IEC 60068-2-6
Environmental	Reach RoHS WEEE

Designed to meet NEMA TS2 & EN 50121-4

Part Numbers.

4 Channel Industrial PoE Injectors

AMG150-4GAT-P120

4 × 10/100/1000BaseT(x) RJ45 In Ports, 4 × 10/100/1000BaseT(x) RJ45 with 30W PoE+ Out Ports, 120W Max PoE Budget

6 Channel Industrial PoE Injectors

AMG150-2GBT-4GAT-P300

6 × 10/100/1000BaseT(x) RJ45 In Ports, 2 × 10/100/1000BaseT(x) RJ45 with 90W PoE++ & 4 × 10/100/1000BaseT(x) RJ45 with 30W PoE+ Out Ports, 300W Max PoE Budget

8 Channel Industrial PoE Injectors

AMG150-8GAT-P240

8 × 10/100/1000BaseT(x) RJ45 In Ports, 8 × 10/100/1000BaseT(x) RJ45 with 30W PoE+ Out Ports, 240W Max PoE Budget

AMG150-4GBT-4GAT-P480

8 × 10/100/1000BaseT(x) RJ45 In Ports, 4 × 10/100/1000BaseT(x) RJ45 with 90W PoE++ & 4 × 10/100/1000BaseT(x) RJ45 with 30W PoE+ Out Ports, 480W Max PoE Budget

Included Accessories.

DIN Rail Adapter

Rear Mounted Metal DIN Rail Clip & Screws For DIN Rail Mounting AMG150 Series Products

Wall Mounting Brackets

2x Wall Mounting Brackets & Screws For Wall / Surface Mounting AMG150 Series Products

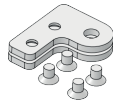
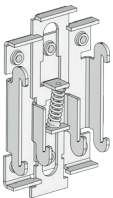

Recommended PSUs.

AMGPSU-I48L-P120

DIN-Rail Mounting Light Industrial Grade PSU, -20 to +60°C, 48-55VDC, 120W

AMGPSU-I48-P120

DIN-Rail Mounting Industrial Grade PSU, -40 to +70°C, 47-53VDC, 120W

AMGPSU-I48-P240

DIN-Rail Mounting Industrial Grade PSU, -40 to +70°C, 48-53VDC, 240W

AMGPSU-I48-P480

DIN-Rail Mounting Industrial Grade PSU, -40 to +70°C, 48-55VDC, 480W

Proud to be a British
Manufacturer 

In a continuing effort to improve and advance technology, product specifications are subject to change without notice. Please visit www.amgsystems.com for the latest product specifications.

AMG Systems Ltd. 3 The Omega Centre, Stratton Business Park, Biggleswade, Bedfordshire, SG18 8QB, UK
T :: +44 (0) 1767 600 777 E :: sales@amgsystems.com
D33393-01

amgsystems.com

AMG